

0053083 CSP BUSCH2910.15Q EXNR C111 ST.FLP.0WC.27C001850000BNGC (06/10/02)

Stock # 2632

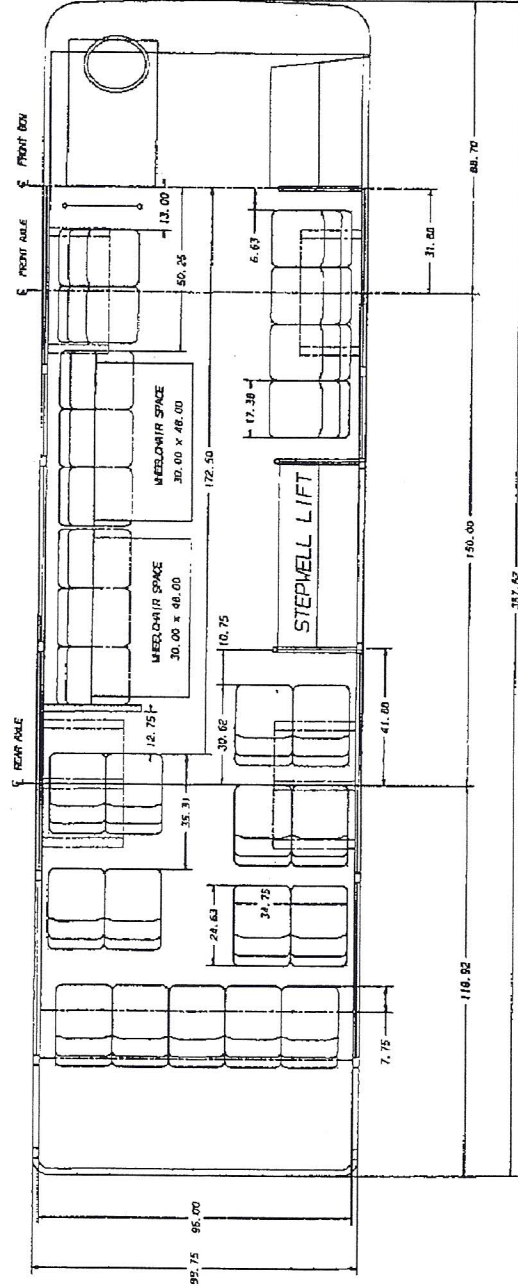

PREDICTION BODY PLAN: ELECTRONIC
 BODY SECTIONS FRONT TO REAR:
 5-28, 2-35, 2-30 L.H., R.H. (EXIT 4R)
 5-28, 2-35, 2-30 L.H.
 TSW WINDOW SECTIONS FRONT TO REAR:
 55, 28, 70, 55 R.H.
 55, 28, 56, 70, 56 L.H.
 T.O. REQUIRED FOR: WHEELCHAIR SEATING
 PROVISIONS IN THIS PRINT IN NO WAY RELIGATES
 BLUE BUS CORPORATION TO BUILD ONLY SEAT
 PREPARED FOR: FLORIDA TRANSPORTATION

THIS SEATPLAN ALSO CAN BE USED WITH
 AMERICAN 6460 SEATS

REV.	DATE	DESCRIPTION
1		BLUE BUS CORPORATION
2		FLORIDA TRANSPORTATION
3		FLORIDA TRANSPORTATION
4		FLORIDA TRANSPORTATION
5		FLORIDA TRANSPORTATION
6		FLORIDA TRANSPORTATION
7		FLORIDA TRANSPORTATION
8		FLORIDA TRANSPORTATION
9		FLORIDA TRANSPORTATION
10		FLORIDA TRANSPORTATION
11		FLORIDA TRANSPORTATION
12		FLORIDA TRANSPORTATION
13		FLORIDA TRANSPORTATION
14		FLORIDA TRANSPORTATION
15		FLORIDA TRANSPORTATION
16		FLORIDA TRANSPORTATION
17		FLORIDA TRANSPORTATION
18		FLORIDA TRANSPORTATION
19		FLORIDA TRANSPORTATION
20		FLORIDA TRANSPORTATION
21		FLORIDA TRANSPORTATION
22		FLORIDA TRANSPORTATION
23		FLORIDA TRANSPORTATION
24		FLORIDA TRANSPORTATION
25		FLORIDA TRANSPORTATION
26		FLORIDA TRANSPORTATION
27		FLORIDA TRANSPORTATION
28		FLORIDA TRANSPORTATION
29		FLORIDA TRANSPORTATION
30		FLORIDA TRANSPORTATION
31		FLORIDA TRANSPORTATION
32		FLORIDA TRANSPORTATION
33		FLORIDA TRANSPORTATION
34		FLORIDA TRANSPORTATION
35		FLORIDA TRANSPORTATION
36		FLORIDA TRANSPORTATION
37		FLORIDA TRANSPORTATION
38		FLORIDA TRANSPORTATION
39		FLORIDA TRANSPORTATION
40		FLORIDA TRANSPORTATION
41		FLORIDA TRANSPORTATION
42		FLORIDA TRANSPORTATION
43		FLORIDA TRANSPORTATION
44		FLORIDA TRANSPORTATION
45		FLORIDA TRANSPORTATION
46		FLORIDA TRANSPORTATION
47		FLORIDA TRANSPORTATION
48		FLORIDA TRANSPORTATION
49		FLORIDA TRANSPORTATION
50		FLORIDA TRANSPORTATION
51		FLORIDA TRANSPORTATION
52		FLORIDA TRANSPORTATION
53		FLORIDA TRANSPORTATION
54		FLORIDA TRANSPORTATION
55		FLORIDA TRANSPORTATION
56		FLORIDA TRANSPORTATION
57		FLORIDA TRANSPORTATION
58		FLORIDA TRANSPORTATION
59		FLORIDA TRANSPORTATION
60		FLORIDA TRANSPORTATION
61		FLORIDA TRANSPORTATION
62		FLORIDA TRANSPORTATION
63		FLORIDA TRANSPORTATION
64		FLORIDA TRANSPORTATION
65		FLORIDA TRANSPORTATION
66		FLORIDA TRANSPORTATION
67		FLORIDA TRANSPORTATION
68		FLORIDA TRANSPORTATION
69		FLORIDA TRANSPORTATION
70		FLORIDA TRANSPORTATION
71		FLORIDA TRANSPORTATION
72		FLORIDA TRANSPORTATION
73		FLORIDA TRANSPORTATION
74		FLORIDA TRANSPORTATION
75		FLORIDA TRANSPORTATION
76		FLORIDA TRANSPORTATION
77		FLORIDA TRANSPORTATION
78		FLORIDA TRANSPORTATION
79		FLORIDA TRANSPORTATION
80		FLORIDA TRANSPORTATION
81		FLORIDA TRANSPORTATION
82		FLORIDA TRANSPORTATION
83		FLORIDA TRANSPORTATION
84		FLORIDA TRANSPORTATION
85		FLORIDA TRANSPORTATION
86		FLORIDA TRANSPORTATION
87		FLORIDA TRANSPORTATION
88		FLORIDA TRANSPORTATION
89		FLORIDA TRANSPORTATION
90		FLORIDA TRANSPORTATION
91		FLORIDA TRANSPORTATION
92		FLORIDA TRANSPORTATION
93		FLORIDA TRANSPORTATION
94		FLORIDA TRANSPORTATION
95		FLORIDA TRANSPORTATION
96		FLORIDA TRANSPORTATION
97		FLORIDA TRANSPORTATION
98		FLORIDA TRANSPORTATION
99		FLORIDA TRANSPORTATION
100		FLORIDA TRANSPORTATION

SECTION FRAME 1 JUNE 10, 2002 07.14.58